

Header icons: N Shift: Range: Gain L2:6.0 L1:6.0 H2:6.0 H1:6.0

(1) Range Mode: Blank:Manual, Auto Range:Auto Range, Auto Shift:Auto Shift

(2) Normal/Zoom: Normal, Zoom

(3) Shift status: Same, Individ.

(4) Range status: Same, Individ.

(5) Gain setting: H1:Hi-Freq.1, H2:Hi-Freq.2, L1:Lo-Freq.1, L2:Lo-Freq.2

(6) CM status: CM1 ~ CM6

(7) Alarm set status] key assignment: Arrival, Bottom, W. Temp, XTE, Fish, Speed

(8) Image Speed: Speed-2~1, Stop, Speed2, Speed3~9

(9) [EVENT] key assignment: Store Position, Store Image, Homing

(10) [F1] [F2] key assignment: Shift Digit Input, A Scope, kHz Frequency, IR, Image Swap, Event Key Usage, Color Erase, Image Title, Key Lock, Noise Rejection, VRM Interval, Depth Unit, Background Color, NAV Start, Color Tone, TVG Adjust, Image Recall, B.D. Mode, White Line, Sona-Tone (only for CVS-702D)

(11) SD Card* (12) USB Memory* ***(11)(12) are only for CVS-705D/707D**

Explanation of header icons

Gain adjustment

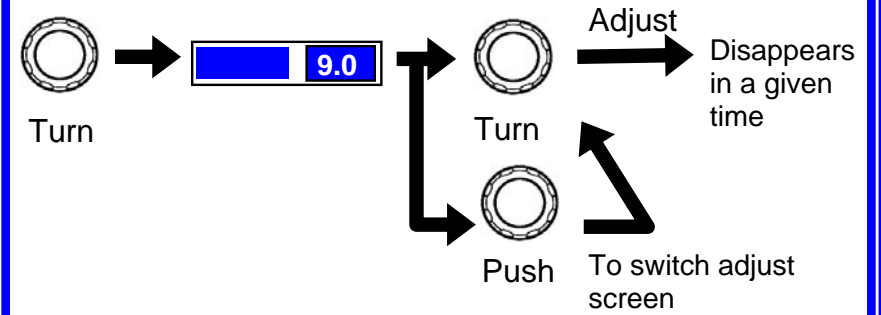

To adjust gain, use the following GAIN knob:

- 1 screen: GAIN-R knob
- 2 screens: GAIN-R knob for the right screen, GAIN-L knob for the left
- 3/4 screens: GAIN-R knob for the 2 right screens, GAIN-L knob for 2 left. Use GAIN-R knob for the middle screen, in case of 3 screens.

Select Range ([▲RANGE▼] key)

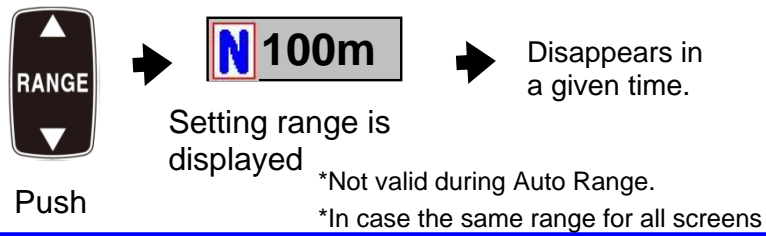

Set Shift ([▲SHIFT▼] key)

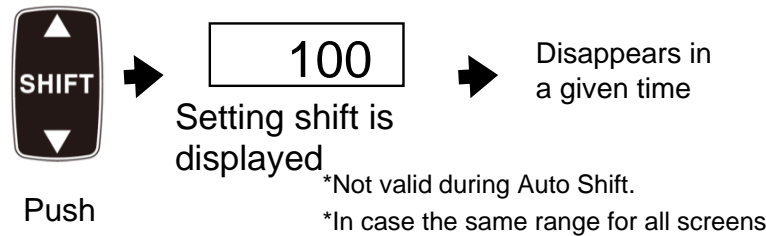

Turn OFF Shift ([SHIFT/M]OFF key)

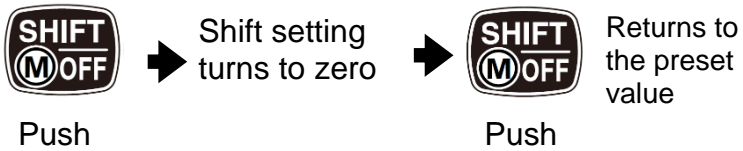

Power ON/OFF ([BRILL] key)

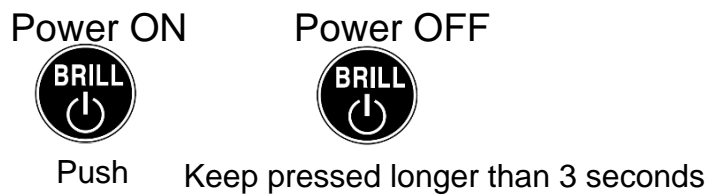

Adjust Brightness ([BRILL] key)

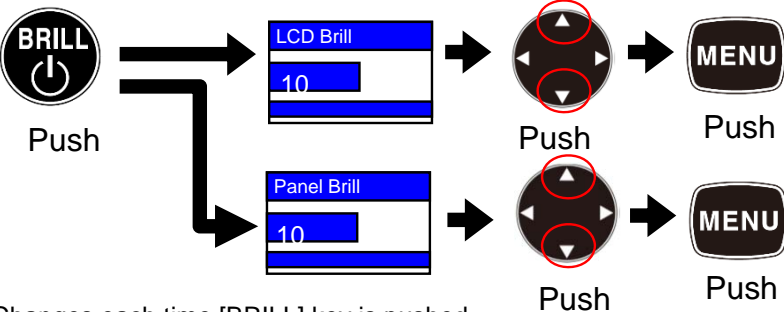

*Changes each time [BRILL] key is pushed.
*Only Panel brightness adjustment is not available for CVS-707D.

Select Settings of Saved Function ([F1]/[F2] key)

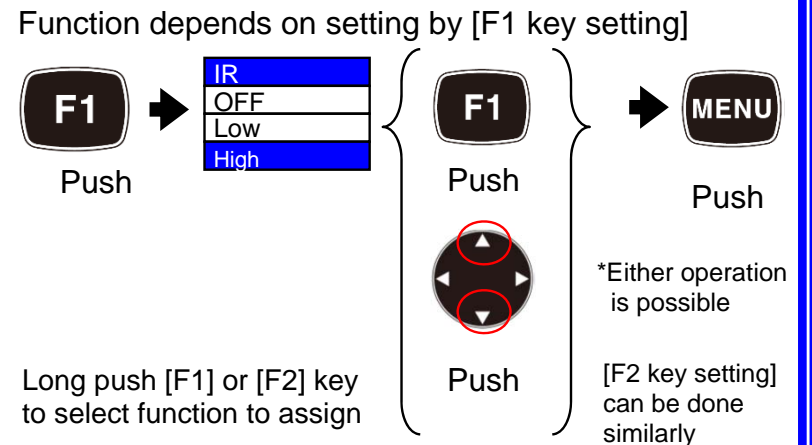

Store Position / Store Image ([EVENT] key)

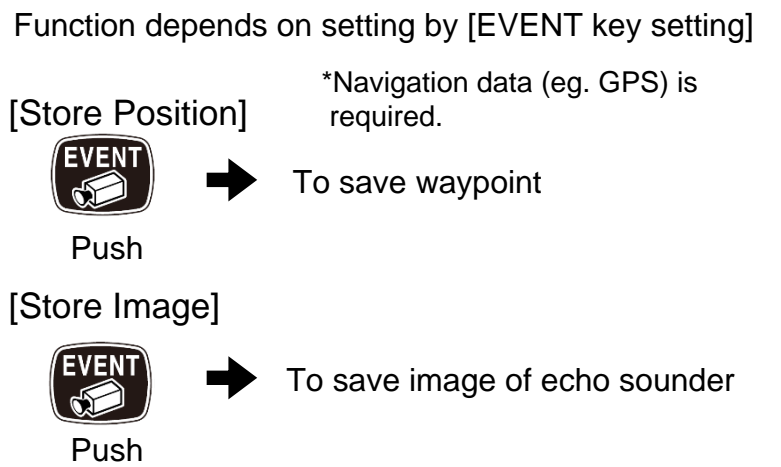

Display Menu List ([MENU] key)



*To open menu list, or sub-menu list

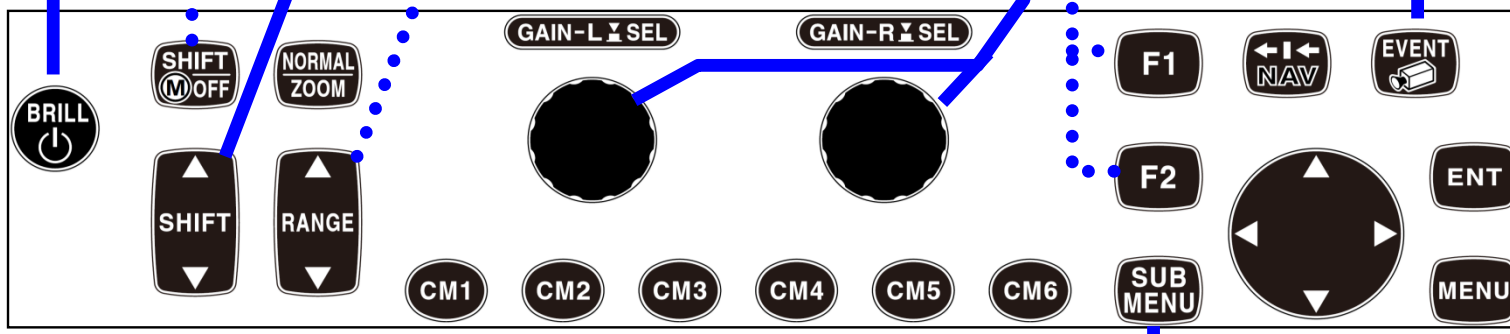

● To operate menu

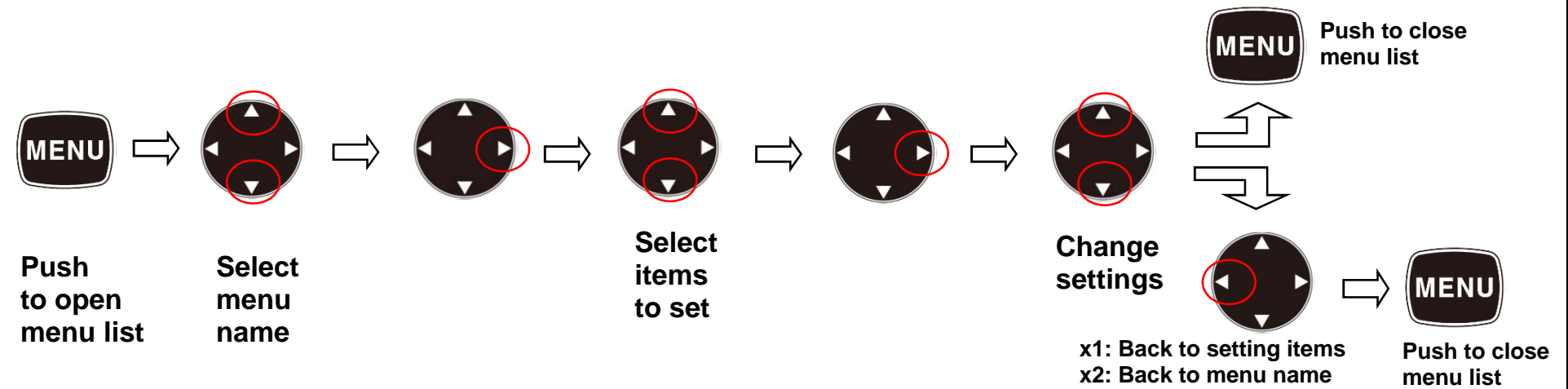

● To change contents of CM (Condition Memory) keys

One set of the setting values can be switched by using CM keys. Some setting items are in common use, such as language selection, types of Transducers, etc.

Switching by CM1 to CM6 keys makes it possible to use functions as if you were using 6 different echo sounders.

You can switch the settings simply by pushing buttons, among the preferred values saved for different fish types, seasons, fishing points.

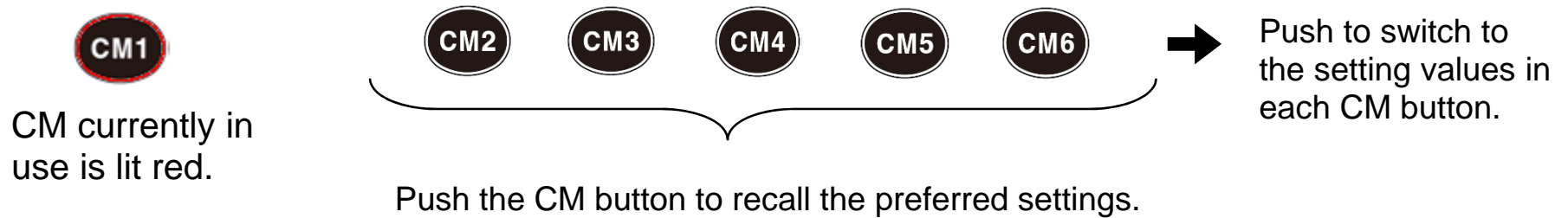

● To change zoom range and shift position of partial zoom

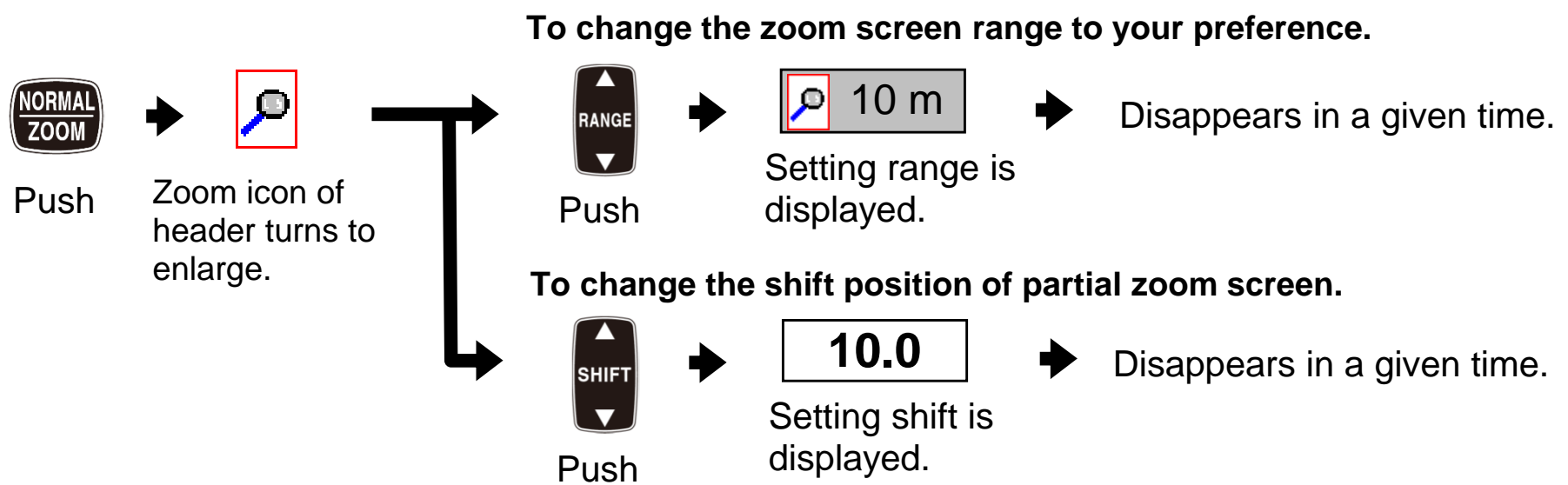

● To change contents of CM Menu

Settings for screen configuration, adding zoom screen and frequency change can be done in the CM menu to your preference.

